

1411276046 APPENDIX A – SCOPE OF WORK
PROGRESSIVE DESIGN-BUILD SERVICES FOR THE JEA HEADQUARTERS FITNESS CENTER

PREPARED FOR: FACILITIES

PREPARED BY: SALLY JERMANUS

DATE: 5/23/2023

Introduction & Background

The new JEA HQ design plans included a fitness center. The existing plans for the fitness center must be redesigned and reduced to the north section of the available space (approximately 3688sf). RS&H is the TI architect for JEA HQ, HSJ is the low voltage and BAS designer, and Ryan Co is the landlord and bidders must comply with Ryan Companies Rules & Regulations.

Scope

The Design-Build team shall provide all labor, materials, and equipment to redesign and construction of the fitness center at HQ. The center will include exercise equipment, restrooms and lockers for employees use. JEA will provide the existing plans for the original layout of the fitness center at HQ, JEA technical specification and Ryan Co. safety requirements. All work will be performed in accordance with project drawings and these specifications.

The design-build team will work with fitness center staff, safety and security and the rest of the JEA team to determine the final layout.

Original Floorplan of available space:

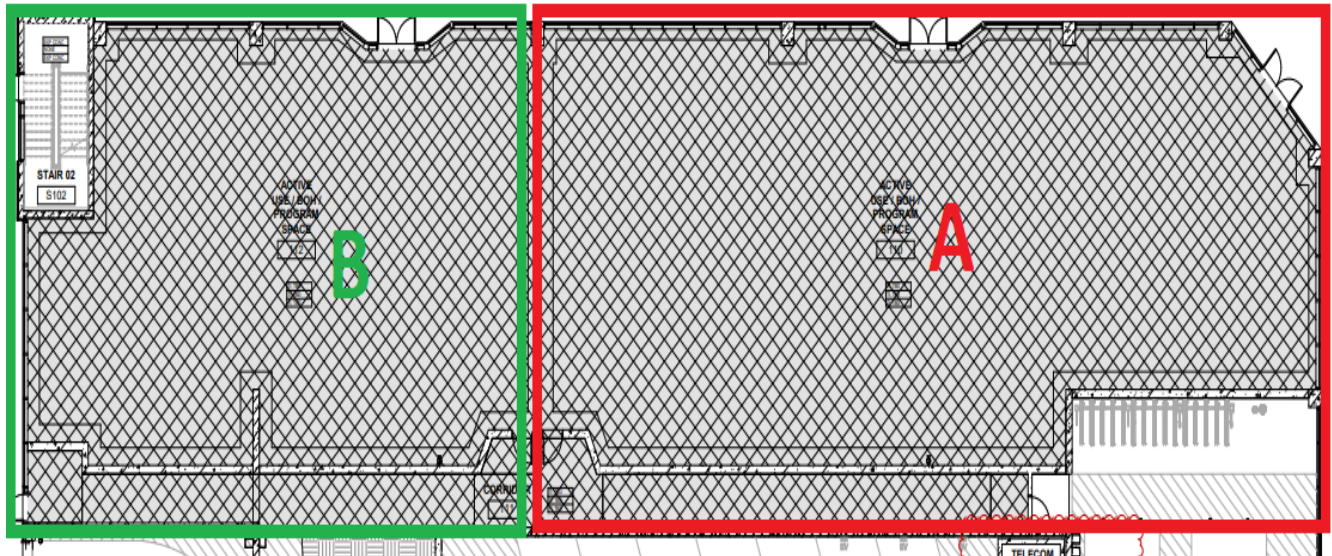

APPENDIX A – SCOPE OF WORK
PROGRESSIVE DESIGN-BUILD SERVICES FOR JEA HQ FITNESS

Original layout of equipment, restrooms, lockers using section A of the total available space:

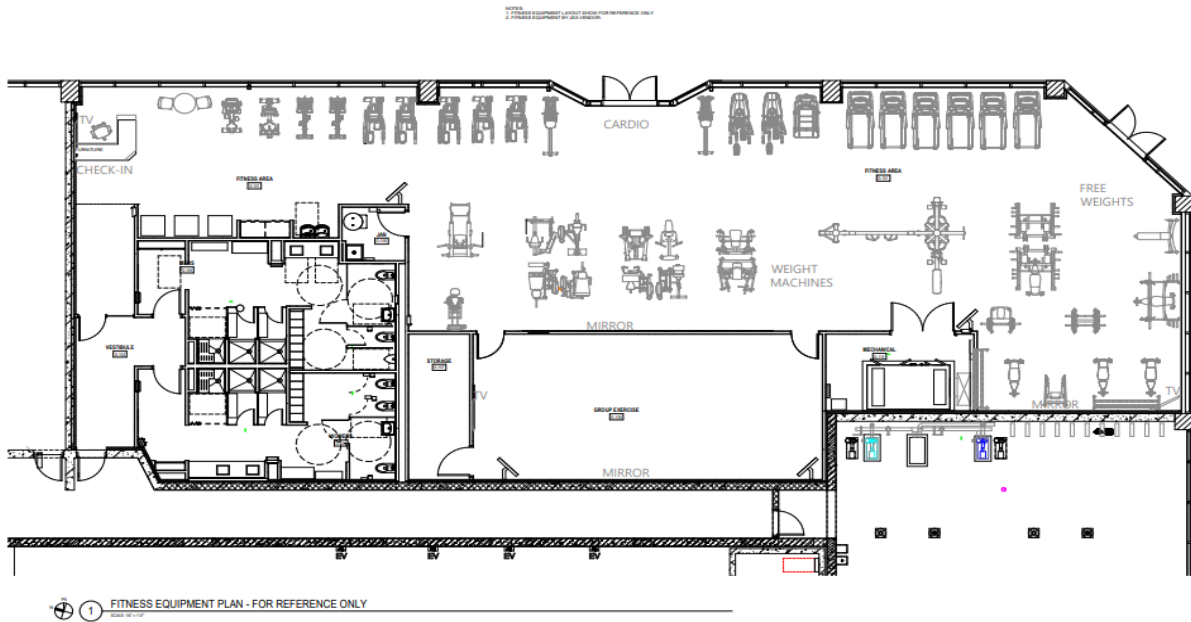

Existing layout above to be redesigned to fit section B only of the total available space, locker highlighted below will remain in section A.

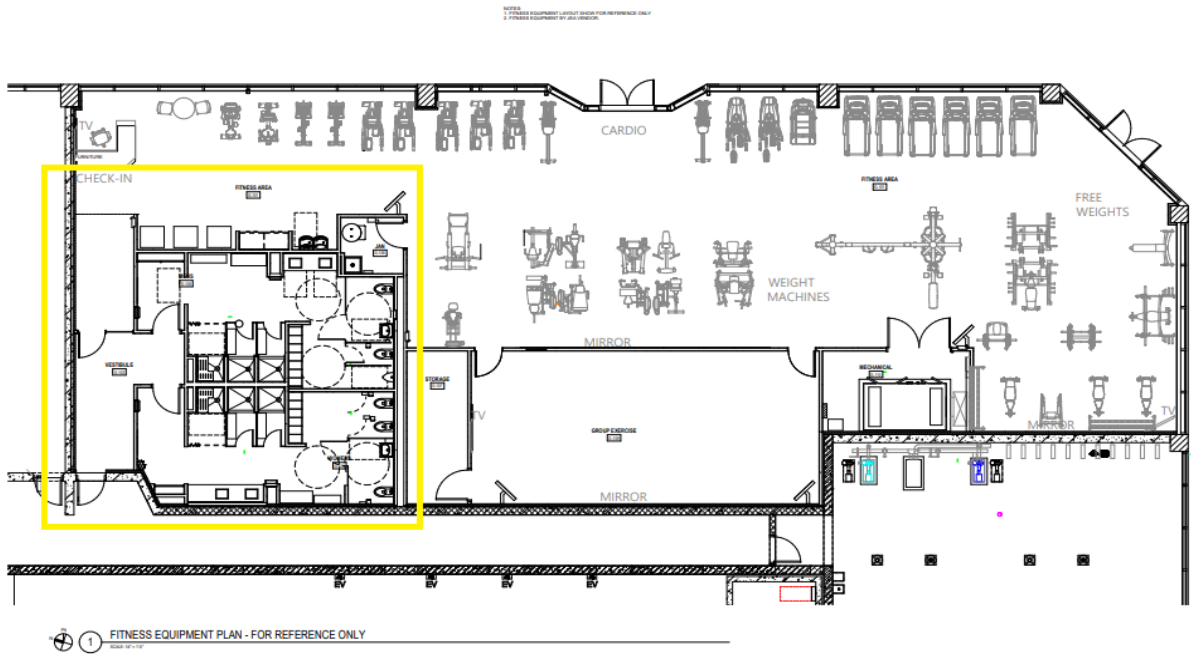

The above images are for reference only and the DB team will work with the JEA team (fitness center staff, security, etc.) to redesign the space to accommodate the needs of the JEA.